

PRESSURE REGULATOR CONVERSION KIT

“PR” TO “PRH” or “PRH” TO “PR” Instructions

The following instructions apply to the conversion of Series “PR” pressure regulators to/from Series “PRH”. In all cases the spring guide will be replaced with a new spring guide. All “PRH” valves use two (2) springs. All “PR” valves, sizes 1/2" - 2" use one (1) spring, PR300 uses two (2) springs.

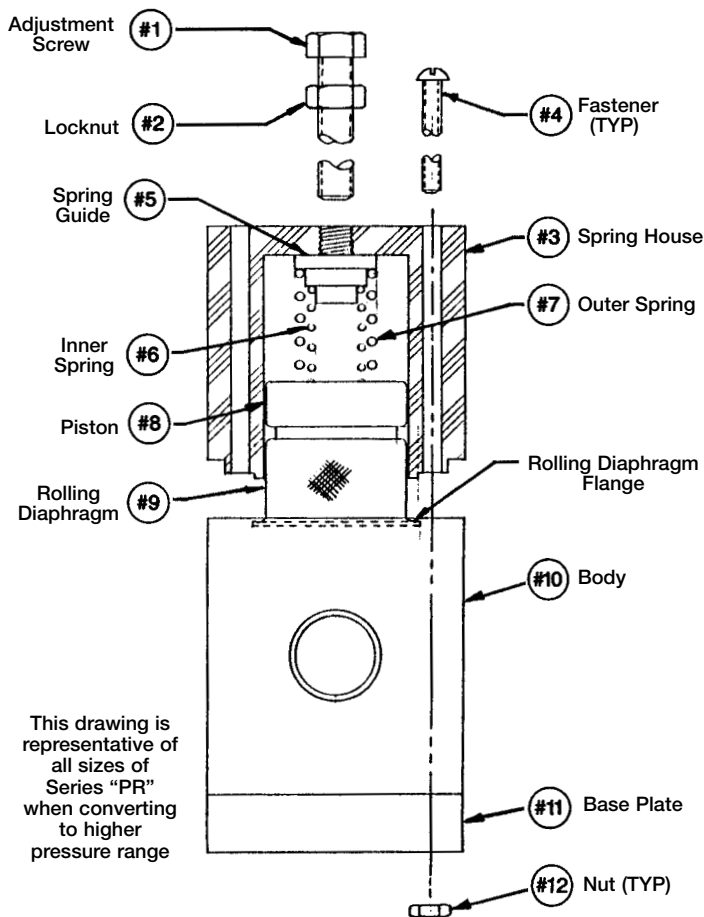

1. **CAUTION:** Relieve pressure and drain liquid from piping and valve before disassembly. Take proper precautions to protect people and equipment from any residual liquids.
2. Remove the adjustment screw and locknut (items #1 and #2) from the spring housing (item #3).
3. Remove screws (item #4).
4. Remove the spring housing (item #3).
5. Remove the spring guide (item #5) and spring(s) (item #6).
6. Place spring(s) (item #6) supplied in the conversion kit in the piston (item #8) of the pressure regulator.
7. Place the new spring guide (item #5) supplied, in the conversion kit on top of the spring(s) as shown.
8. Re-install the spring housing (item #3) and fasten the screws (item #4). When installing the spring housing, avoid creasing or pinching the rolling diaphragm (item #9) and be sure that the flange of the rolling diaphragm is seated flatly against the recess machined into the pressure regulator body (item #10).
9. Inspect the pressure regulator for external leaks before use.