

## Mounting CAFE/CAFE NITRO to Plast-O-Matic Ball Valve

1. Ensure the ball valve and the actuator are set to the closed position. The ball valve stem must be perpendicular to the flow direction, see drawing view
2. Thread the (2) mounting studs (item 3) into the mounting plate (item 2). Refer to the mounting plate detail view to determine which holes in the mounting plate are used for the appropriate valve size. Thread the studs into the bracket so that they are approximately flush with the top of the mounting plate. Use of a thread locking fluid, such as Loctite threadlocker is recommended.
3. Install the mounting plate (item 2) onto the actuator (item 1) using the (4) Assembly screws (item 4). Tighten to 40 in.lbs. Use of a thread locking fluid, such as Loctite threadlocker is recommended.
4. Install the coupler (item 5) onto the shaft of the ball valve (item 7). Assemble the ball valve (item 7) onto the actuator (item 1). The coupler (item 5) is inserted into the output drive of the actuator and the mounting studs go through the spacers (item 6) and the ball valve mounting lugs.
5. Install the hex nuts (item 8) onto the mounting studs (item 3) and tighten. For 3/8"-1" valves, tighten to 15 in.Lbs. for 1-1/4" - 2" valves, tighten to 25 in.Lbs.

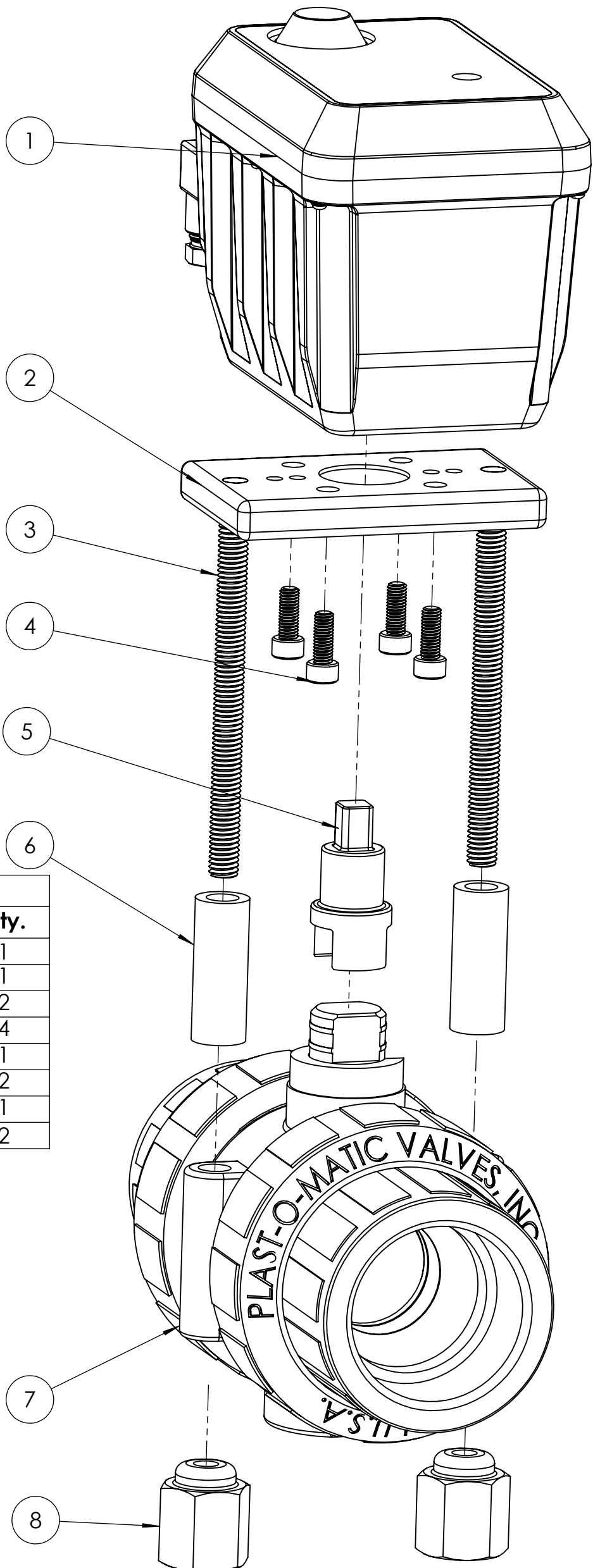

Mounting Kit Components		
Item No.	Description	Qty.
1	Cafe or Cafe Nitro Actuator	1
2	Mounting Plate	1
3	Mounting Studs	2
4	Assembly Screws	4
5	Coupler	1
6	Spacers	2
7	2-Way or 3-Way Ball Valve	1
8	Hex Nuts	2

### MOUNTING PLATE DETAIL

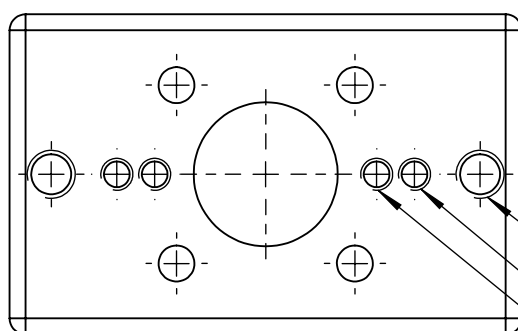

**Valve Size**  
 1-1/4", 1-1/2" & 2"  
 3/4" & 1"  
 3/8" & 1/2"



SCAN FOR  
COMPLETE  
INSTRUCTIONS