

SERIES "MBV/TMBV" 2-WAY & 3-WAY TRUE UNION MANUAL BALL VALVES 3" & 4" SIZES

FEATURES:

- Full port.
- Bi-directional flow.
- Low maintenance and extended operational life.
- Handle equipped as a spanner device to adjust carrier.
- PTFE seat energized by O-ring.
- Ball machined and tumbled to ensure roundness.
- Special mounting pads are molded on body for actuator mounting or valve anchoring.
- Blow-out proof stem.
- Safety shear stem design.
- Double O-ring seal on stem.

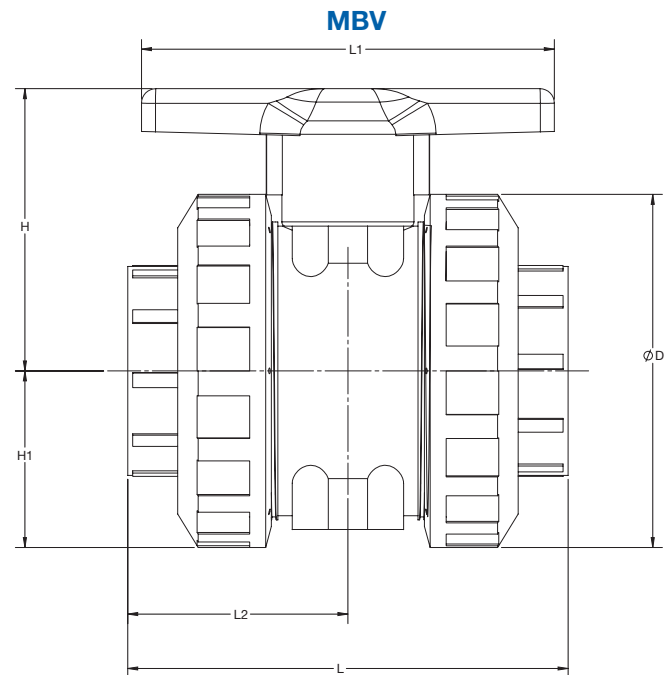
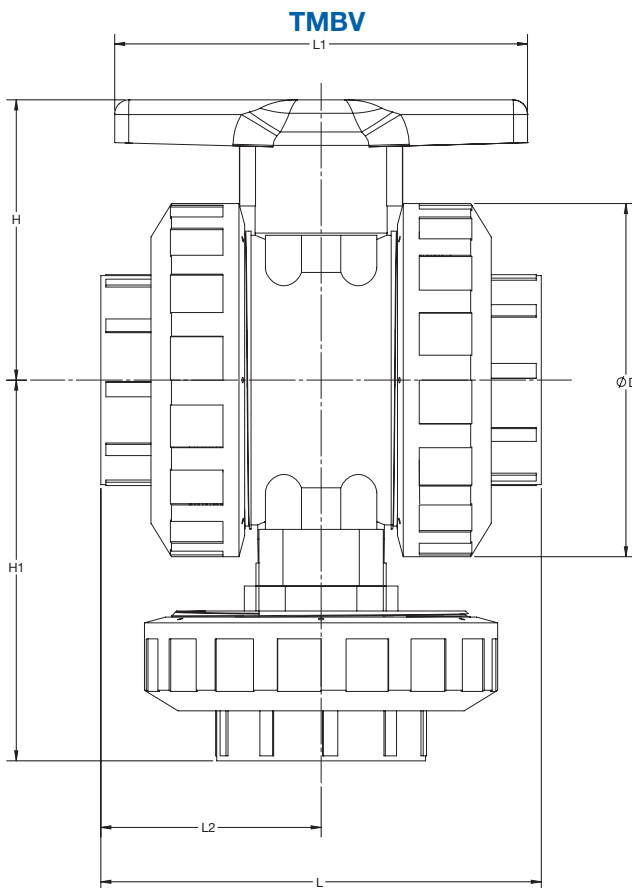

MODEL	L		L1		L2		D		H		H1	
	IN	MM	IN	MM	IN	MM	IN	MM	IN	MM	IN	MM
MBV300	10.8	274.3	9.1	230	5.3	134	7.1	181.1	6.5	165	3.7	94.2
MBV400	12.6	320.0	10.8	274.3	5.7	145.6	9.2	233.6	7.4	186.7	4.6	116.8
TMBV300	10.8	274.3	9.1	230	5.3	134	7.1	181.1	6.5	165	8.3	210.3
TMBV400	12.6	320.0	10.8	274.3	5.7	145.6	9.2	233.6	7.4	186.7	9.9	251.8

MATERIAL GUIDELINE FOR PRESSURE & TEMPERATURE

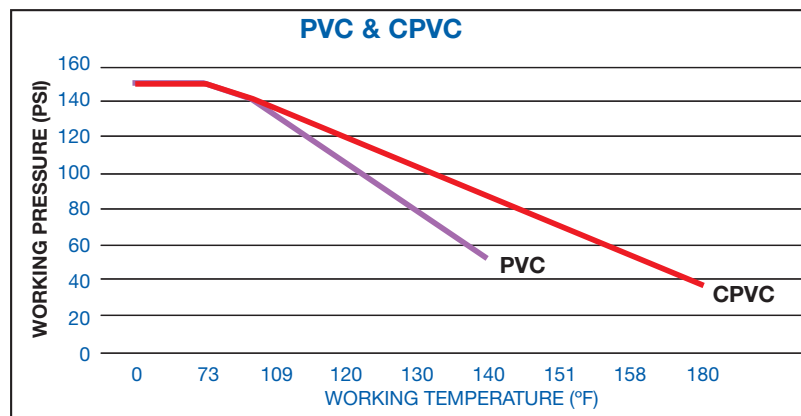
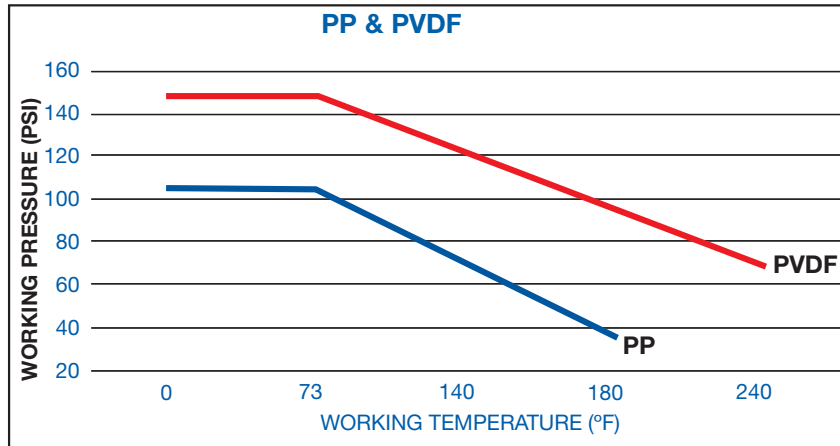

MATERIALS OF CONSTRUCTION:

PVC: Class 1245B per ASTM D1784

CPVC: Class 1245B per ASTM D1784

PP: Class PP 110B76383 per ASTM D4101

PVDF: Type 1 per ASTM D3222

Seals: EPDM or FKM

Seats: PTFE

ORDERING INFORMATION

2-Way Valve Size	Cv Factor	PVC Model #	CPVC Model #	Polypro Model #	PVDF Model #
3", 2-way	490	MBV300VT-PV	MBV300VT-CP	MBV300VT-PP	MBV300VT-PF
4", 2-way	770	MBV400VT-PV	MBV400VT-CP	MBV400VT-PP	MBV400VT-PF
3 Way Valve Size	Cv Factor	PVC Model #	CPVC Model #	Polypro Model #	PVDF Model #
3", 3-way	132	TMBV300VT-PV-A	TMBV300VT-CP-A	N/A	N/A
4", 3-way	200	TMBV400VT-PV-A	TMBV400VT-CP-A	N/A	N/A

NOTES:

1. Model numbers shown are with FKM (Viton) seals. For EPDM seals, change the second "V" to "EP".
2. Model numbers shown are with threaded connections. For socket connections, change the "T" to "S".
3. Model numbers listed with "-A" denote 3-hole ball.